

Radiator

Illustrated Index



Carbureted Engine:

WARNING

System is under high pressure when engine is hot. To avoid danger of releasing scalding coolant, remove cap only when engine is cool.

CAUTION: When supplying coolant, be sure to shut the relay box lid and not to let coolant spill on the electrical parts or the painted portion. If any coolant spills, rinse it off immediately.

Total Cooling System Capacity (including expansion tank 0.55 l (0.58 US qt, 0.48 Imp qt) and heater):

1.4 l

M/T: 5.4 l (5.7 US qt, 4.8 Imp qt)

A/T: 5.3 l (5.6 US qt, 4.7 Imp qt)

1.6 l

M/T: 5.5 l (5.8 US qt, 4.8 Imp qt)

A/T: 5.4 l (5.7 US qt, 4.8 Imp qt)

NOTE:

- Check all cooling system hoses for damage, leaks or deterioration and replace if necessary.
- Check all hose clamps and retighten if necessary.
- Use new O-rings when reassembling.

RADIATOR

Refilling page 5-84

Leak test, page 5-85

Inspect seams between core fins and tanks for leaks. Blow dirt out from between core fins with compressed air. If insects, etc., are clogging radiator, wash them off with low pressure water.

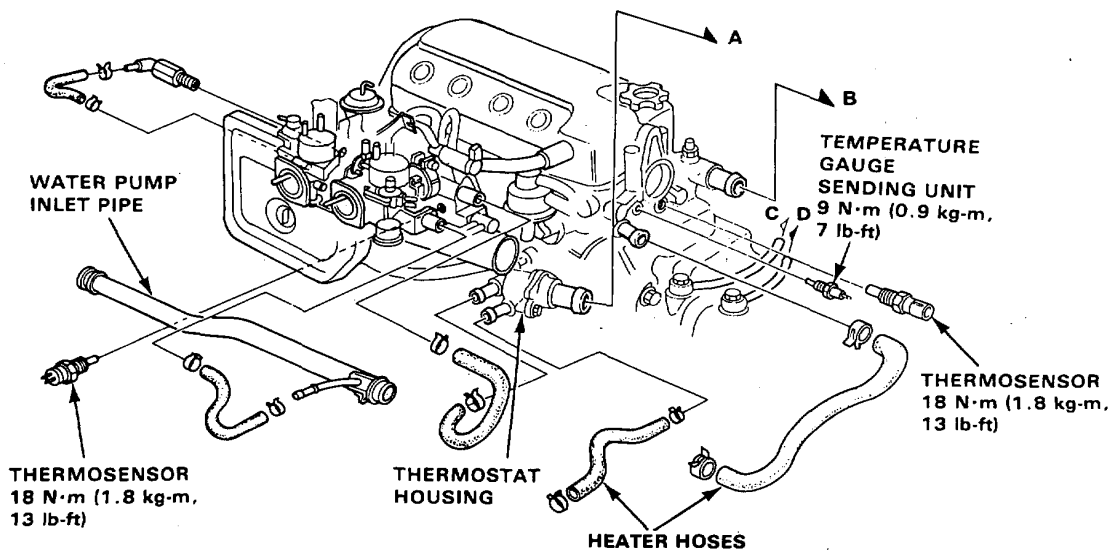
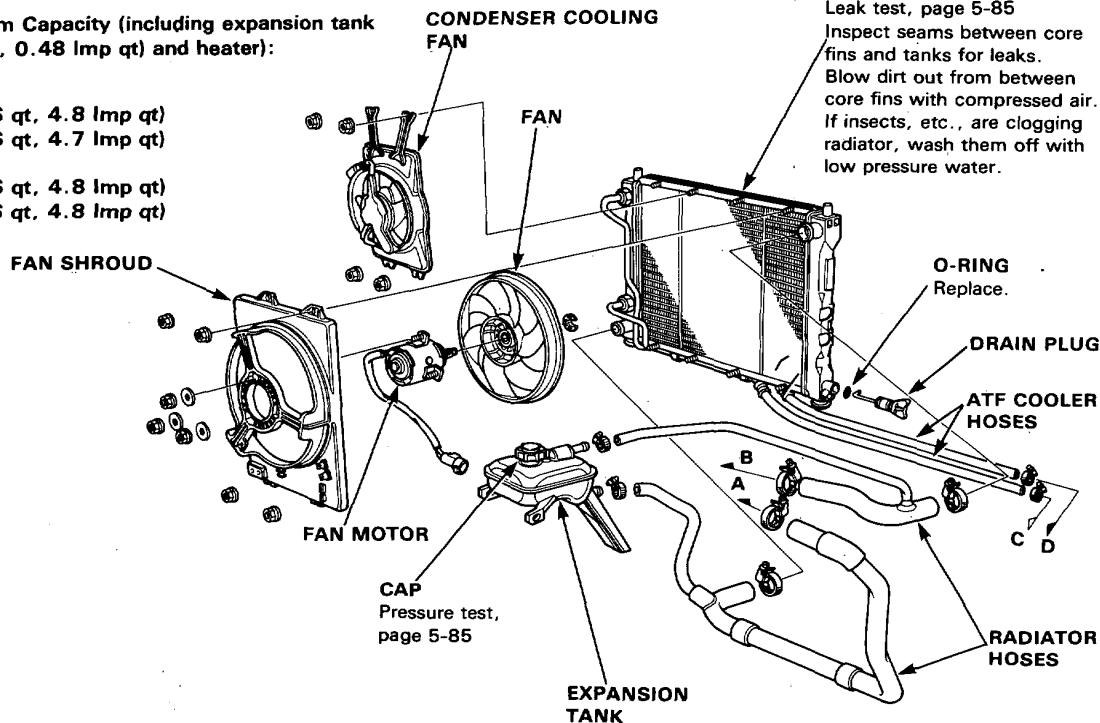

Radiator

Illustrated Index

DOHC Fuel-Injected Engine:

⚠ WARNING System is under high pressure when engine is hot. To avoid danger of releasing scalding coolant, remove cap only when engine is cool.

CAUTION: When supplying coolant, be sure to shut the relay box lid and not to let coolant spill on the electrical parts or the painted portion. If any coolant spills, rinse it off immediately.

Total Cooling System Capacity (including expansion tank 0.55 ℓ (0.58 US qt, 0.48 Imp qt) and heater):

M/T 5.5 ℓ (5.8 US qt, 4.8 Imp qt)

A/T 5.4 ℓ (5.7 US qt, 4.8 Imp qt)

NOTE:

- Check all cooling system hoses for damage, leaks or deterioration and replace if necessary.
- Check all hose clamps and retighten if necessary.
- Use new O-rings whenever reassembling.

RADIATOR

Refilling, page 5-84

Leak test, page 5-85

Inspect seams between core fins and tanks for leaks.

Blow dirt out from between core fins with compressed air.

If insects, etc., are clogging radiator, wash them off with low pressure water.

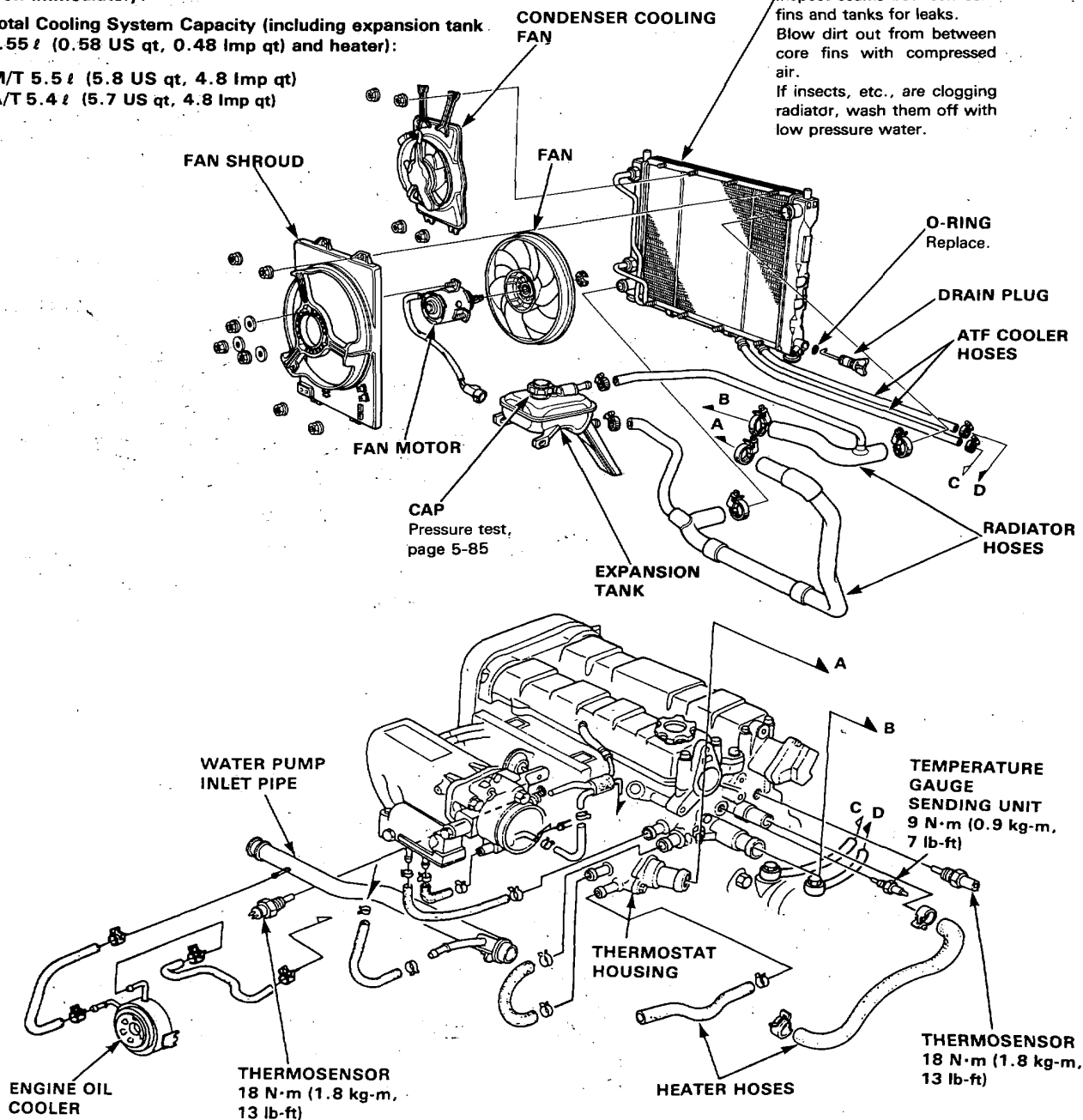



1.5 l Fuel-Injected

⚠ WARNING

System is under high pressure when engine is hot. To avoid danger of releasing scalding coolant, remove cap only when engine is cool.

CAUTION: When supplying coolant, be sure to shut the relay box lid and not to let coolant spill on the electrical parts or the painted portion. If any coolant spills, rinse it off immediately.

Total Cooling System Capacity (including expansion tank 0.55 l (0.58 US qt, 0.48 Imp qt) and heater):

M/T: 5.5 l (5.8 US qt, 4.8 Imp qt)

A/T: 5.4 l (5.7 US qt, 4.8 Imp qt)

NOTE:

- Check all cooling system hoses for damage, leaks or deterioration and replace if necessary.
- Check all hose clamps and retighten if necessary.
- Use new O-rings when reassembling.

RADIATOR

Refilling, page 5-84

Leak test, page 5-85

Inspect seams between core fins and tanks for leaks.

Blow dirt out from between core fins with compressed air. If insects, etc., are clogging radiator, wash them off with low pressure water.

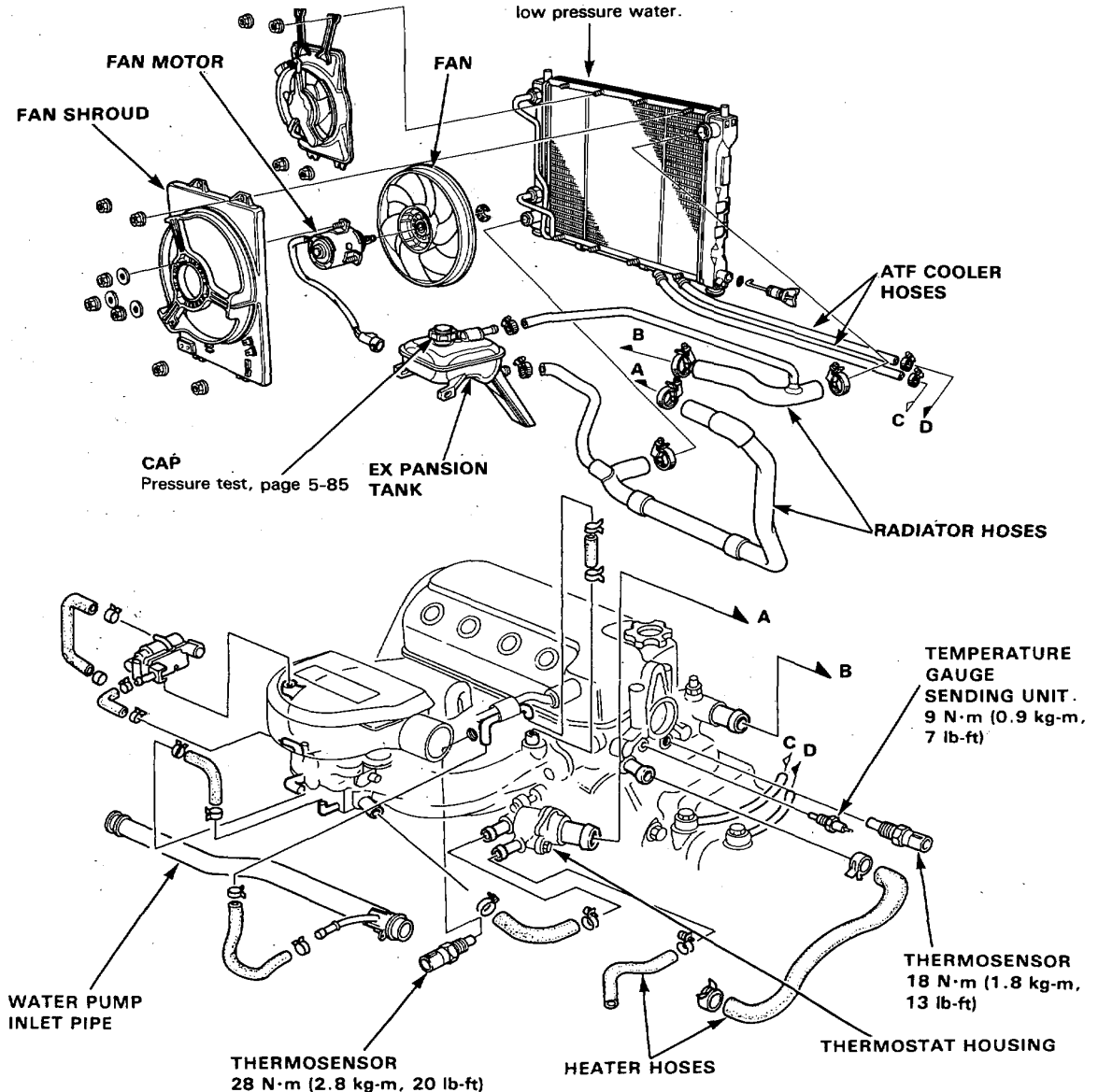

Radiator

Illustrated Index

1.6 SOHC Fuel-Injected

WARNING System is under high pressure when engine is hot. To avoid danger of releasing scalding coolant, remove cap only when engine is cool.

CAUTION: When supplying coolant, be sure to shut the relay box lid and not to let coolant spill on the electrical parts or the painted portion. If any coolant spills, rinse it off immediately.

Total Cooling System Capacity (including expansion tank 0.55 ℓ (0.58 US qt, 0.48 Imp qt) and heater):

M/T: 5.4 ℓ (5.7 US qt, 4.8 Imp qt)

A/T: 5.3 ℓ (5.6 US qt, 4.7 Imp qt)

NOTE:

- Check all cooling system hoses for damage, leaks or deterioration and replace if necessary.
- Check all hose clamps and retighten if necessary.
- Use new O-rings when reassembling.

